

OPEN FIBRE FIBRE OPTIC INFRASTRUCTURE

As-Built - Drakenstein Sentrum

T. 087 245 0800
 E. info@openfibre.co.za
 A. 220 Jan Smuts Avenue, Dunkeld West, 2196
 W. openfibre.co.za



Survey information

Surveyed by:	Tiaan du Toit	Company:	RSS Fibre	Date:	07/05/2021
Phone Number:	061 923 0612	Email Address:	tiaandutoit0@gmail.com		

Project information

Contractor	RSS Fibre				
Project Manager	Tiaan du Toit	Phone Number:	061 923 0612		
Call out/Drop Team Leader:	Tiaan du Toit	Phone Number:	061 923 0612		

SITE INFORMATION:

Area:	Cape Town	Building Name:	Drakenstein Sentrum
Site Address:	Corner of Wemmershoek Road and Lustigan Road	Suburb:	Brackenfell
Site Owner:	Openfibre	Centre Manager Contact:	TBC
Latitude:	-33.764583°	Longitude:	18.984813°
Number of Floors:	1	Number of Connections:	32



Cable Requirements:

Entry Duct	2 way 12/10 mm		4 way 12/10 mm		7 way 12/10 mm	
Feeder Fibre:	12F	24F	48F	72F	96F	144F
Feeder Duct:	2 way 12/10 mm		4 way 12/10 mm		7 way 12/10 mm	
Drop Duct:	2 way 8/5 mm	4 way 8/5 mm	7 way 8/5 mm	12 way 12/10 mm		
MMR Power:	AC Plug point available			Power Plant Required		

Notes:

- 42U Cabinet to be installed.
- 2 Way 12/10 Duct installed.
- 24F Fibre Cable installed inside 2 Way 12/10 Duct.
- 2 Core Boxes installed on site as indicated on As-Built.
- 3 Access Boxes installed on site as indicated on As-Built.
- Ducts saddled on cable trays inside ceiling area.
- Drop Cables installed on cable trays from their provisioned Access Box towards the shop.
- 24F Distribution Joint installed at existing HH1



INSTALLATION APPROVAL

Name:	Name:
Date:	Date:
Signature	Signature



Project No:	Rev:	Date:	Page
RSS-OPF-0023	000	29/10/2021	1 of 9

Hereby I confirm that this Installation Plan is approved for installation and that the installation can continue accordingly with the installation dates indicated prior to installation start date.



491m

- Trenched 1000mm deep for 110m.
- Horizontal Directional Drill for 41m.
- Hauled duct in existing 110mm sleeve for 340m.

Colour Legend

	Installed 42U Cabinet		Existing 2 Way 12/10		4F Drop Cable Route				
	Installed Core Box		Existing 2 Way 12/10 + 24F						
	Installed Access Box		24F Micro Cable						



Project No:	Rev:	Date:
RSS-OPF-0023	000	29/10/2021



Colour Legend

	Installed 42U Cabinet		Existing 2 Way 12/10		4F Drop Cable Route				
	Installed Core Box		Existing 2 Way 12/10 + 24F						
	Installed Access Box		24F Micro Cable						



Project No:	Rev:	Date:
RSS-OPF-0023	000	29/10/2021

Ducting Overview ISP

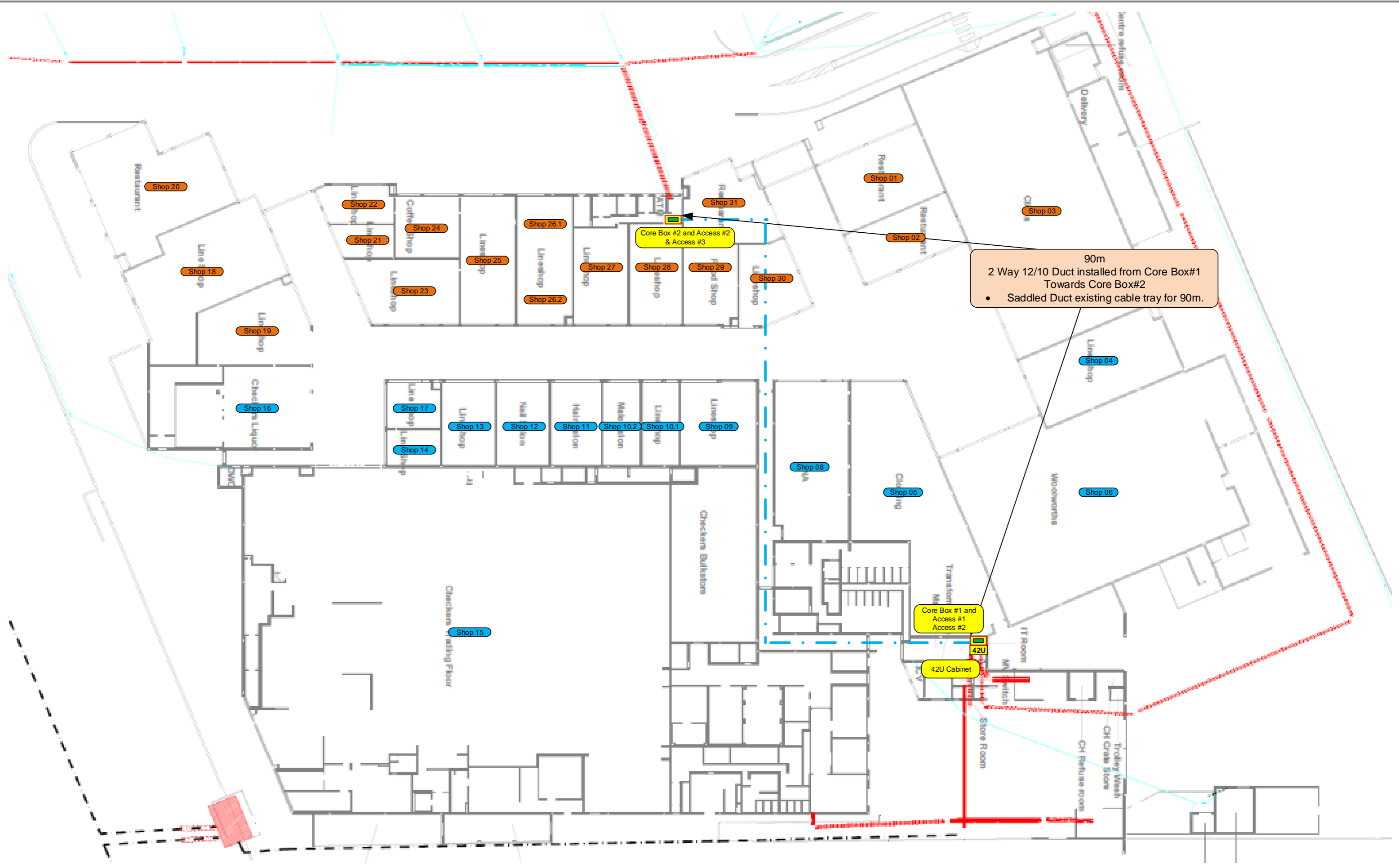

90m
2 Way 12/10 Duct installed from Core Box#1
Towards Core Box#2
• Saddled Duct existing cable tray for 90m.

Core Box #1 and
Access #1
Access #2

Core Box #2 and Access #2
& Access #3

42U Cabinet

Colour Legend

42U	Installed 42U Cabinet	—	Existing 2 Way 12/10	—	4F Drop Cable Route
■	Installed Core Box	—	Existing 2 Way 12/10 + 24F		
■	Installed Access Box	—	24F Micro Cable		



Project No:	Rev:	Date:
RSS-OPF-0023	000	29/10/2021

Ducting and Fibre Overview

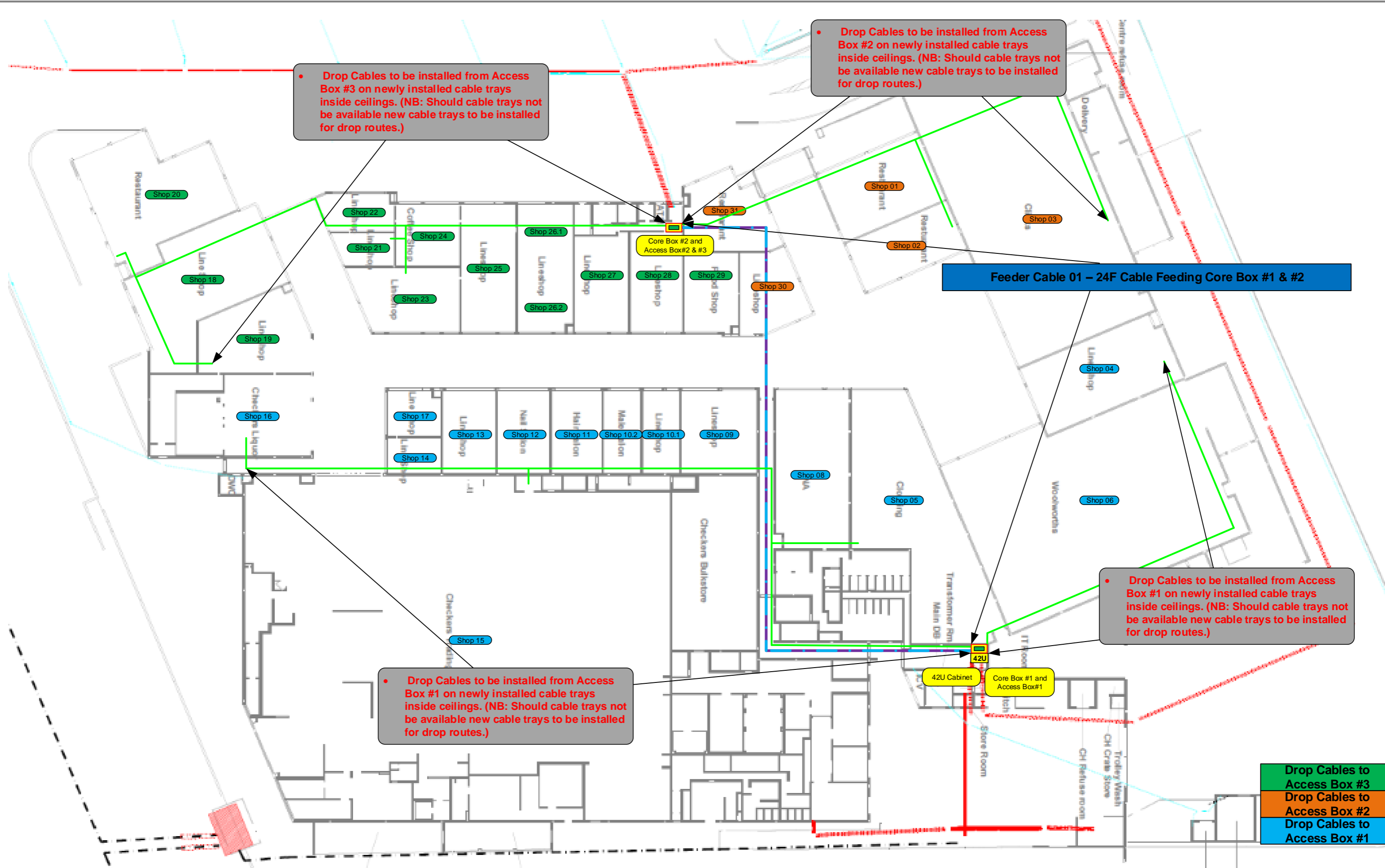

Drop Cables to be installed from Access Box #3 on newly installed cable trays inside ceilings. (NB: Should cable trays not be available new cable trays to be installed for drop routes.)

Drop Cables to be installed from Access Box #2 on newly installed cable trays inside ceilings. (NB: Should cable trays not be available new cable trays to be installed for drop routes.)

Drop Cables to be installed from Access Box #1 on newly installed cable trays inside ceilings. (NB: Should cable trays not be available new cable trays to be installed for drop routes.)

Drop Cables to be installed from Access Box #1 on newly installed cable trays inside ceilings. (NB: Should cable trays not be available new cable trays to be installed for drop routes.)

Feeder Cable 01 - 24F Cable Feeding Core Box #1 & #2

Drop Cables to Access Box #3
 Drop Cables to Access Box #2
 Drop Cables to Access Box #1

Colour Legend

	Installed 42U Cabinet		Existing 2 Way 12/10		4F Drop Cable Route
	Installed Core Box		Existing 2 Way 12/10 + 24F		
	Installed Access Box		24F Micro Cable		



Project No:	Rev:	Date:
RSS-OPF-0023	000	29/10/2021

Shop Overview

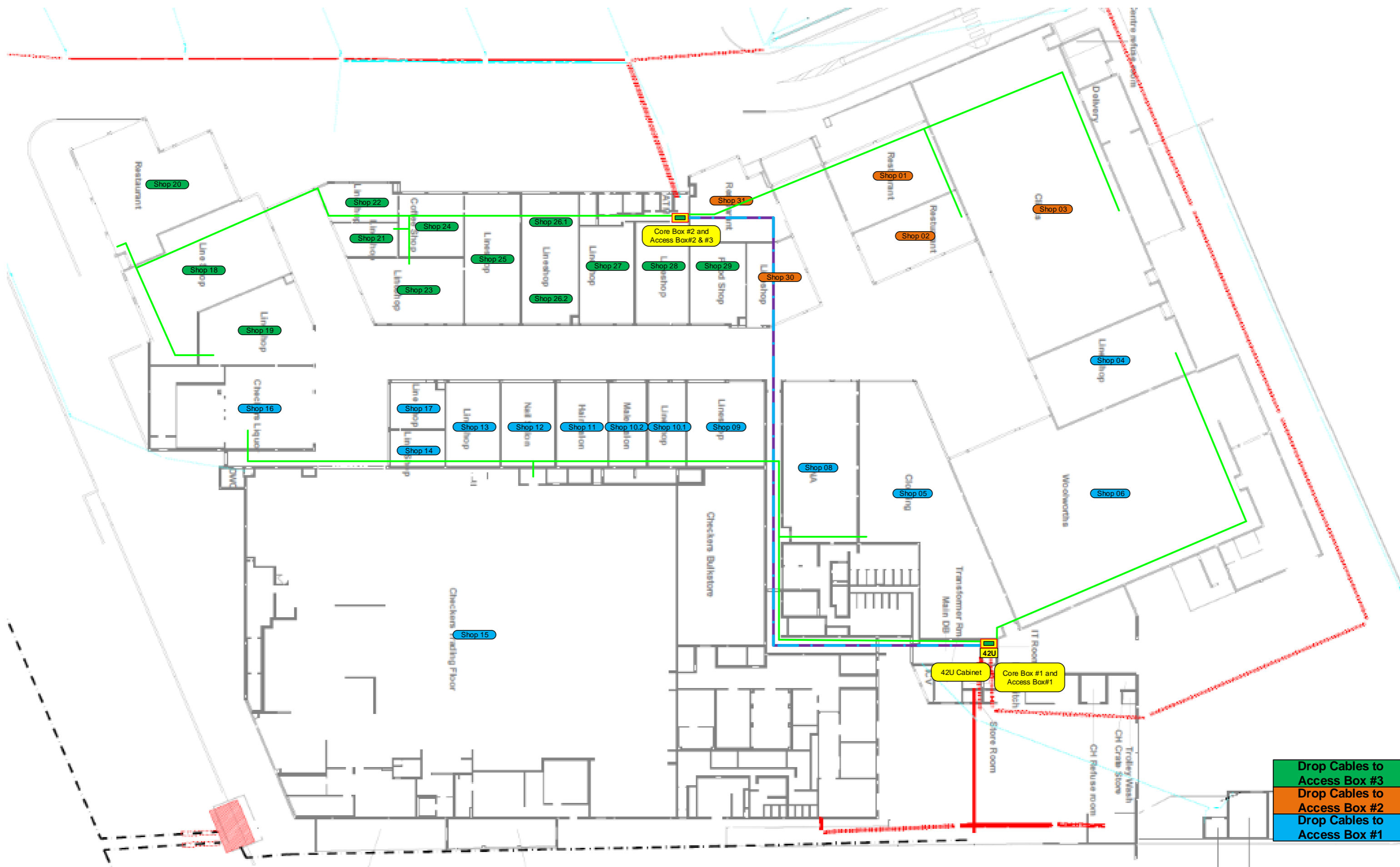

Drop Cables to Access Box #3
 Drop Cables to Access Box #2
 Drop Cables to Access Box #1

Colour Legend

42U	Installed 42U Cabinet		Existing 2 Way 12/10		4F Drop Cable Route
	Installed Core Box		Existing 2 Way 12/10 + 24F		
	Installed Access Box		24F Micro Cable		



Project No:	Rev:	Date:
RSS-OPF-0023	000	29/10/2021

Splicing diagram: Feeder Cable 01

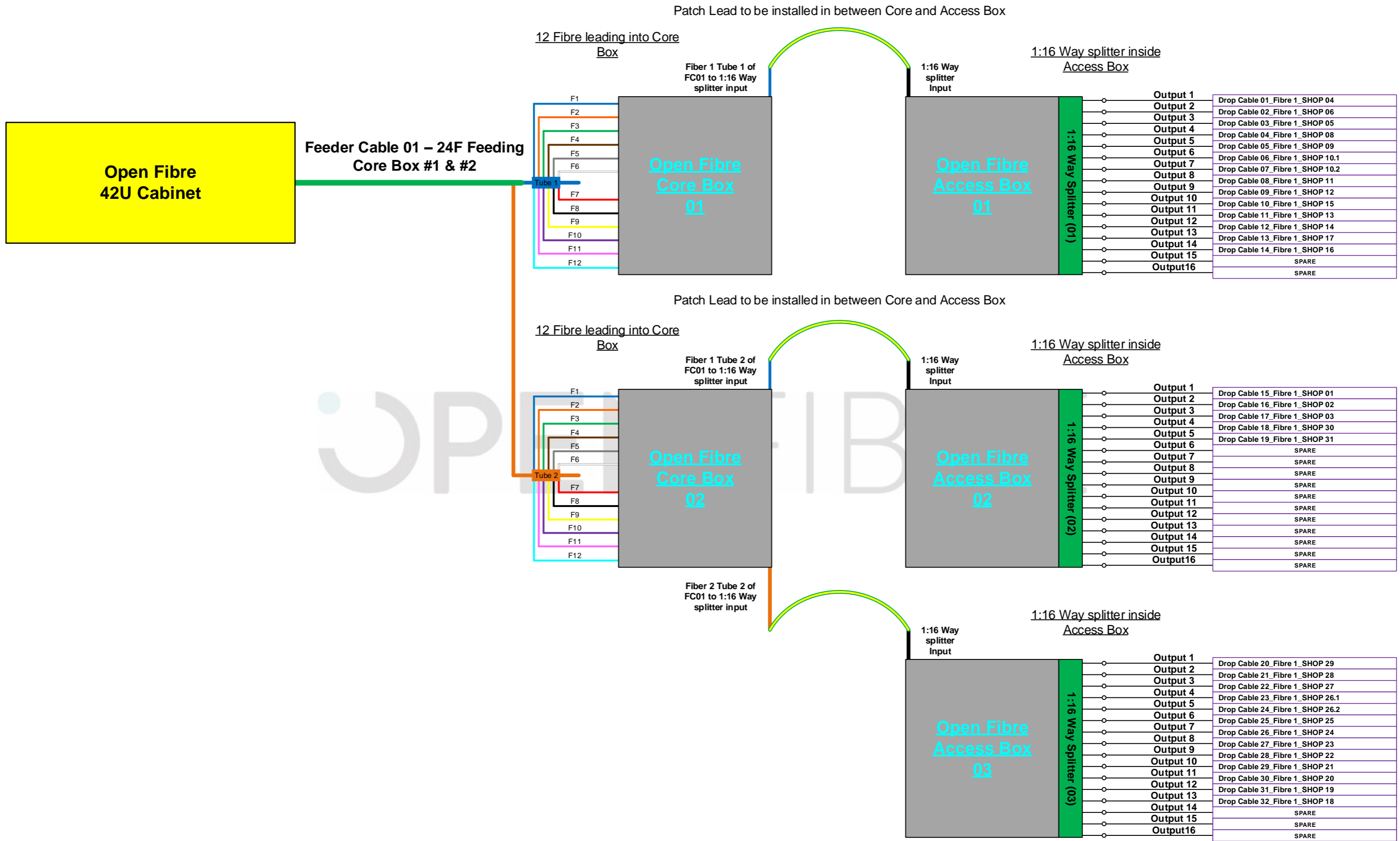

Output	Drop Cable
Output 1	Drop Cable 01_Fibre 1_SHOP 04
Output 2	Drop Cable 02_Fibre 1_SHOP 06
Output 3	Drop Cable 03_Fibre 1_SHOP 05
Output 4	Drop Cable 04_Fibre 1_SHOP 08
Output 5	Drop Cable 05_Fibre 1_SHOP 09
Output 6	Drop Cable 06_Fibre 1_SHOP 10.1
Output 7	Drop Cable 07_Fibre 1_SHOP 10.2
Output 8	Drop Cable 08_Fibre 1_SHOP 11
Output 9	Drop Cable 09_Fibre 1_SHOP 12
Output 10	Drop Cable 10_Fibre 1_SHOP 15
Output 11	Drop Cable 11_Fibre 1_SHOP 13
Output 12	Drop Cable 12_Fibre 1_SHOP 14
Output 13	Drop Cable 13_Fibre 1_SHOP 17
Output 14	Drop Cable 14_Fibre 1_SHOP 16
Output 15	SPARE
Output 16	SPARE

Output	Drop Cable
Output 1	Drop Cable 15_Fibre 1_SHOP 01
Output 2	Drop Cable 16_Fibre 1_SHOP 02
Output 3	Drop Cable 17_Fibre 1_SHOP 03
Output 4	Drop Cable 18_Fibre 1_SHOP 30
Output 5	Drop Cable 19_Fibre 1_SHOP 31
Output 6	SPARE
Output 7	SPARE
Output 8	SPARE
Output 9	SPARE
Output 10	SPARE
Output 11	SPARE
Output 12	SPARE
Output 13	SPARE
Output 14	SPARE
Output 15	SPARE
Output 16	SPARE

Output	Drop Cable
Output 1	Drop Cable 20_Fibre 1_SHOP 29
Output 2	Drop Cable 21_Fibre 1_SHOP 28
Output 3	Drop Cable 22_Fibre 1_SHOP 27
Output 4	Drop Cable 23_Fibre 1_SHOP 26.1
Output 5	Drop Cable 24_Fibre 1_SHOP 26.2
Output 6	Drop Cable 25_Fibre 1_SHOP 25
Output 7	Drop Cable 26_Fibre 1_SHOP 24
Output 8	Drop Cable 27_Fibre 1_SHOP 23
Output 9	Drop Cable 28_Fibre 1_SHOP 22
Output 10	Drop Cable 29_Fibre 1_SHOP 21
Output 11	Drop Cable 30_Fibre 1_SHOP 20
Output 12	Drop Cable 31_Fibre 1_SHOP 19
Output 13	Drop Cable 32_Fibre 1_SHOP 18
Output 14	SPARE
Output 15	SPARE
Output 16	SPARE

Colour Legend





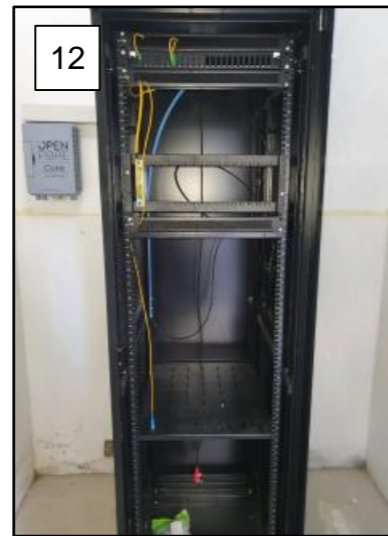
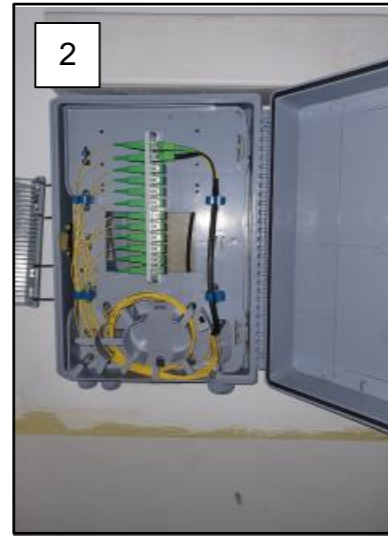
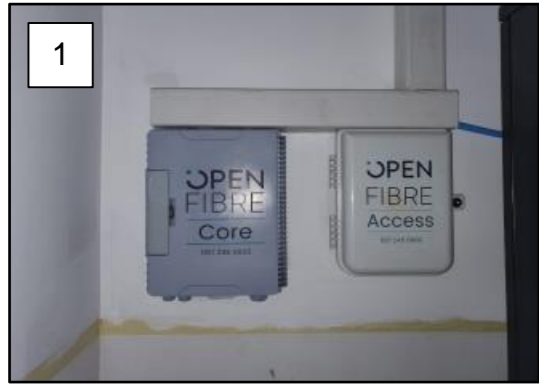

	Installed 42U Cabinet	•	Existing 2 Way 12/10	—	4F Drop Cable Route
	Installed Core Box	—	Existing 2 Way 12/10 + 24F	—	
	Installed Access Box	—	24F Micro Cable	—	



Photo Overview ISP



Colour Legend

	Installed 42U Cabinet		Existing 2 Way 12/10		4F Drop Cable Route					
	Installed Core Box		Existing 2 Way 12/10 + 24F							
	Installed Access Box		24F Micro Cable							









Project No:	Rev:	Date:	Page 8 of 9
RSS-OPF-0023	000	29/10/2021	

Photo Overview OSP



Colour Legend

	Installed 42U Cabinet		Existing 2 Way 12/10		4F Drop Cable Route				
	Installed Core Box		Existing 2 Way 12/10 + 24F						
	Installed Access Box		24F Micro Cable						



Project No:	Rev:	Date:
RSS-OPF-0023	000	29/10/2021